

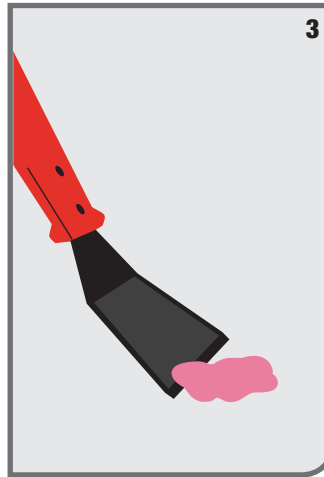

CLEANING INSTRUCTIONS



USES

To safely remove gum from concrete, asphalt, plastic laminate, tile, wood surfaces, carpet and more.

FREQUENCY

As needed

TASK DURATION ⌚

Depends on amount of surface coverage of gum and how extensive the gum may have been embedded into surface. Est. 2-3 min

INSTRUCTIONS:

1. SHAKE WELL BEFORE USING. Insert straw and follow safety precautions on container.
2. Press lightly to spray gum at close distance for 2-5 seconds. Frost will appear.
3. Immediately chip or scrape off brittle gum with RADO gum scraper.

Note: You may require additional spraying for tougher gum removal.



CAUTION: Contents are flammable. Contents are under pressure. Use only as directed.



HAVE QUESTIONS? NEED TRAINING?
WE'RE HERE TO HELP!



Visit www.mycaf.com for additional product information, SDS, training materials, product videos and more.

FAST FREEZING FORMULA	
7.0 OZ (198 g) NET WT	110 APPROX. USES

